

ZINC PLATED STEEL DISC FOR
ATTACHING TO MAGNETS

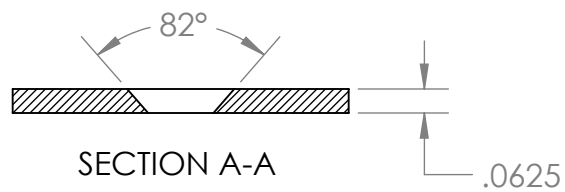

PROPRIETARY AND CONFIDENTIAL	UNLESS OTHERWISE SPECIFIED:	NAME	DATE	
THE INFORMATION CONTAINED IN THIS DRAWING IS THE SOLE PROPERTY OF AMAZING MAGNETS LLC. ANY REPRODUCTION IN PART OR AS A WHOLE WITHOUT THE WRITTEN PERMISSION OF AMAZING MAGNETS LLC IS PROHIBITED.	DIMENSIONS ARE IN INCHES TOLERANCES: FRACTIONAL ± 1/64 ANGULAR: MACH ± 1° TWO PLACE DECIMAL ± 0.01 THREE PLACE DECIMAL ± 0.005	DRAWN	L.Bilisoly	11/21/2014
	MATERIAL:	COMMENTS: ALL EDGES BROKEN 0.025 MAX		
	STEEL			
CAGE CODE 4R1R7	FINISH:			
	ZINC PLATED			
	DO NOT SCALE DRAWING			

 AMAZING MAGNETS®			
TITLE:		ZNSDH063G	
SIZE A	DWG. NO. ZNSDH063G-SPECS	REV 0	