

4

3

2

1

| REVISIONS |      |                 |          |            |
|-----------|------|-----------------|----------|------------|
| ZONE      | REV. | DESCRIPTION     | DATE     | APPROVED   |
| SHEET1    | REVO | INITIAL RELEASE | 1/6/2020 | Spencer W. |

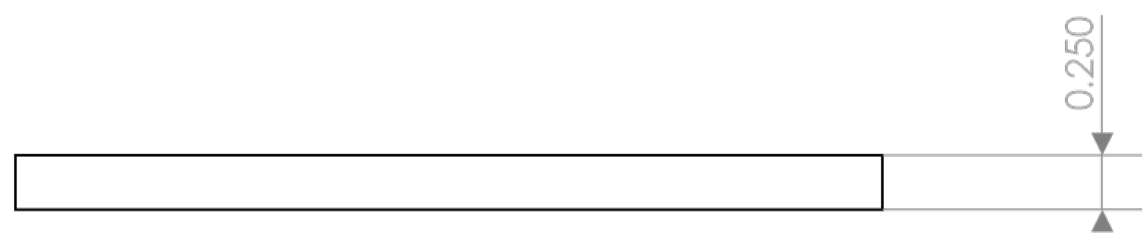
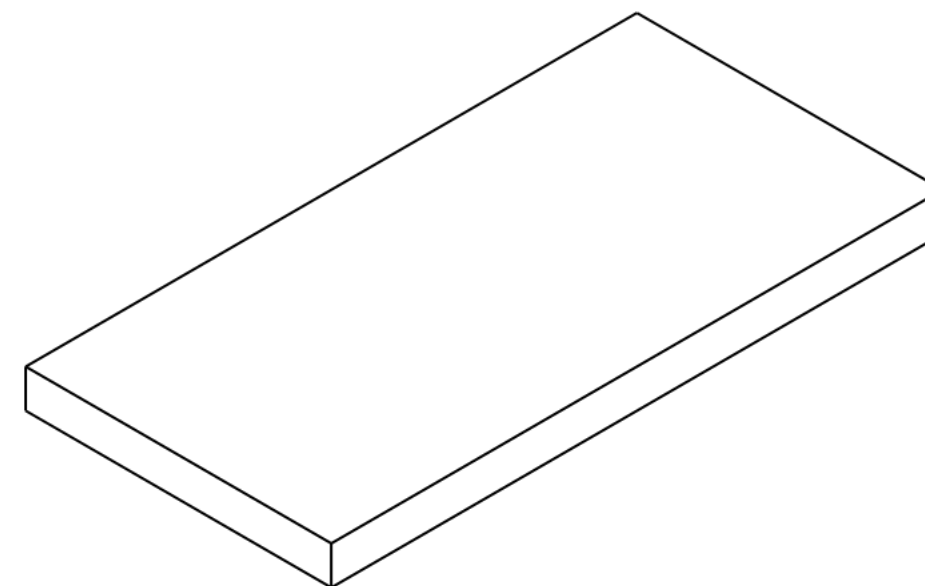

B

B

A

A

CONDITIONS

- PART IS TO BE FREE OF SCRATCHES, DENTS, AND DEFECTS CAUSED DURING PRODUCTION.
- PART IS TO BE FREE OF GREASE, AND DISCOLORATION ON ALL SURFACES.
- PARTS MUST BE PACKAGED IN A MANOR SUITABLE TO AVOID DAMAGE DURING TRANSPORT, STORAGE, AND HANDLING

MAGNETIC PROPERTIES

MATERIAL: LICENSED NdFeB  
 GRADE: N42  
 COATING: Nickel (Ni-Cu-Ni)  
 MAGNETIZED: THICKNESS  
 Br (KG): 12.8-13.2  
 HcB (KOe): ≥11.5  
 Hci (KOe): ≥12.0  
 BHmax (MGOe): 40-43  
 MAXIMUM TEMPERATURE: 80C / 176F

PROPRIETARY AND CONFIDENTIAL

THE INFORMATION CONTAINED IN THIS DRAWING IS THE SOLE PROPERTY OF AMAZING MAGNETS LLC ANY REPRODUCTION IN PART OR AS A WHOLE WITHOUT THE WRITTEN PERMISSION OF AMAZING MAGNETS LLC IS PROHIBITED.

CAGE CODE  
**4R1R7**

UNLESS OTHERWISE SPECIFIED

DIMENSIONS ARE IN INCHES  
 TOLERANCES:  
 ANGULAR: MACH ± 1°  
 TWO PLACE DECIMAL ± 0.005"  
 THREE PLACE DECIMAL ± 0.004"

DO NOT SCALE DRAWING

| NAME               | DATE     |
|--------------------|----------|
| DRAWN Christi P.   | 1/6/2020 |
| CHECKED Spencer W. | 1/6/2020 |

COMMENTS:



TITLE: **P250PY-N42**

| SIZE     | DWG. NO.         | REV      |
|----------|------------------|----------|
| <b>B</b> | P250PY-N42-SPECS | <b>0</b> |

4

3

2

1