

4

3

2

1

REVISIONS				
ZONE	REV.	DESCRIPTION	DATE	APPROVED

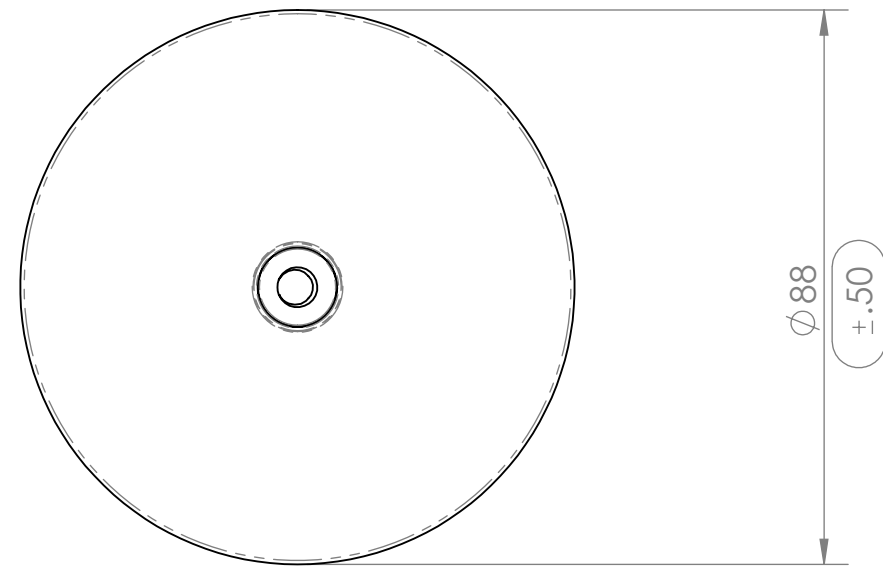

ZINC PLATED
MALE THREADED POST
1/4-20 MACHINE THREAD

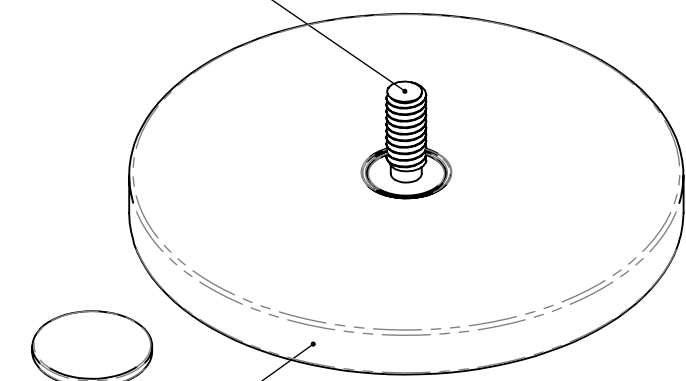

BLACK RUBBER HOUSING

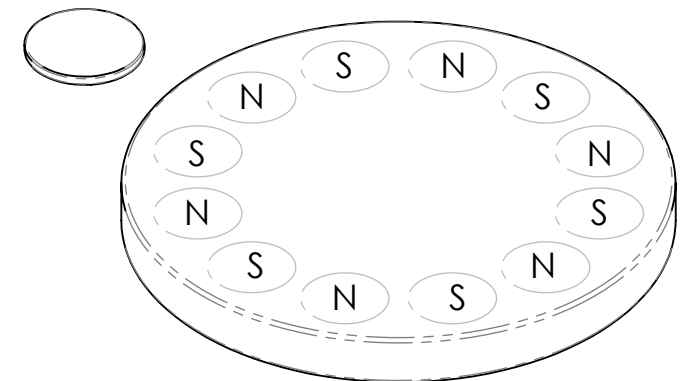
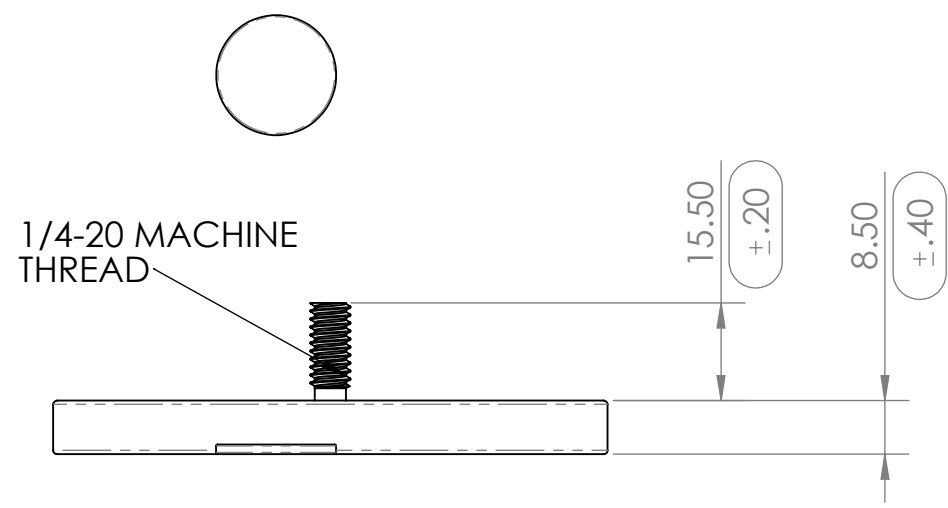

12 INTERNAL MAGNETS
ALTERNATING POLARITY

CONDITIONS

MAGNETIC PROPERTIES

- PART IS TO BE FREE OF SCRATCHES, DENTS, AND DEFECTS CAUSED DURING PRODUCTION.
- PART IS TO BE FREE OF GREASE, AND DISCOLORATION ON ALL SURFACES.

- MATERIAL: LICENSED NdFeB
- GRADE: N35
- COATING: Ni-Cu-Ni (NICKEL-COPPER-NICKEL)
- MAGNETIZED: YES
- RESIDUAL INDUCTION (Br): 11.7-12.2 KOe
- COERCIVE FORCE (Hcb): ≥10.9 KOe
- INTRINSIC COERCIVE FORCE (Hci): ≥12.0 KOe
- MAXIMUM ENERGY PRODUCT (BHmax): 33-36 MGOe
- MAXIMUM OPERATIONAL TEMPERATURE: 80C / 176F

PROPRIETARY AND CONFIDENTIAL

THE INFORMATION CONTAINED IN THIS DRAWING IS THE SOLE PROPERTY OF AMAZING MAGNETS LLC. ANY REPRODUCTION IN PART OR AS A WHOLE WITHOUT THE WRITTEN PERMISSION OF AMAZING MAGNETS LLC IS PROHIBITED.

CAGE CODE
4R1R7

DO NOT SCALE DRAWING

UNLESS OTHERWISE SPECIFIED

DIMENSIONS ARE IN MILLIMETERS
TOLERANCES:
FRACTIONAL ± 1/64
ANGULAR: MACH ± 1°
TWO PLACE DECIMAL ± .12
THREE PLACE DECIMAL ± .08

NAME	DATE
DRAWN: L.Billsoly	11/18/2019
CHECKED: S.Witte	11/18/2019
COMMENTS:	



TITLE: WHEELM3450-N35		
SIZE: B	DWG. NO.: WHEELM3450-N35-SPECS	REV: 0

4

3

2

1

B

B

A

A